



108 Sproat Street Portarlinton VIC

3  2  2 

This is your opportunity to secure a substantial parcel of land (905m2 approx.) with stunning uninterrupted views around the bay and across to the You Yangs. The block is positioned in the heart of Portarlinton within walking distance to the sports ground, direct Ferry to the Docklands, shops, and cafes.

This property offers a range of development opportunities situated on a large corner allotment - including, renovation of the existing dwelling or knock down & build your dream home, STCA build a dual occupancy or create a 2 lot subdivision with magnificent views from either single level or double storey home.

Property Snapshot:

[For full version visit the website](https://www.huntersrealstate.com.au)

Type : House
Price : \$ 980,000
Land Size : 905 sqm
View : <https://www.huntersrealstate.com.au/sale/vic/geelong-district/portarlinton/residential/house/6942315>



Charlotte Hunter
5259 1103

108 Sproat Street, Portarlington

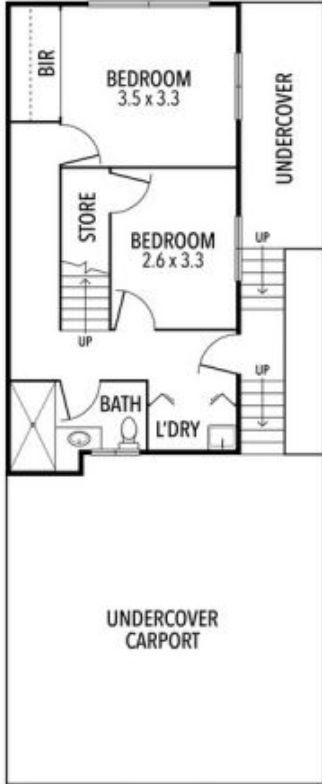

LOWER GROUND FLOOR



GROUND FLOOR



THE ABOVE PLAN IS AN ARTIST'S IMPRESSION ONLY, IT INCLUDES ELEMENTS THAT ARE FOR DISPLAY PURPOSES ONLY AND MAY NOT BE TO SCALE. LANDSCAPING SHOWN IS INDICATIVE ONLY. DIMENSIONS ARE APPROXIMATE.

