



## 6 The Panorama Portarlington VIC

4  2  2 

This contemporary family home is located in the highly sought-after Rise Estate. Boasting four spacious bedrooms, the master features a luxurious ensuite and walk-in robe, while the remaining bedrooms all have built-in robes.

The home's layout is perfect for families, with a separate lounge area providing a cosy retreat for relaxation. The open-plan kitchen and dining area is the heart of the home, complete with reverse cycle air conditioning for year-round comfort. The kitchen is a chef's dream, featuring premium Caesarstone bench tops, stainless steel appliances, a 900mm upright stove, dishwasher, and a large pantry.

Gas ducted heating ensures warmth throughout the home during the cooler months. The seamless flow between the dining area and the alfresco living space makes this home

**Price** : \$880,000  
**Land Size** : 448 sqm  
**View** : <https://www.huntersrealestate.com.au/sale/vic/geelong-district/portarlington/residential/house/7918574>



**Charlotte Hunter**  
0488001094



**Oliver Mullan**  
0492 879 682

## 6 The Panorama, Portarlington

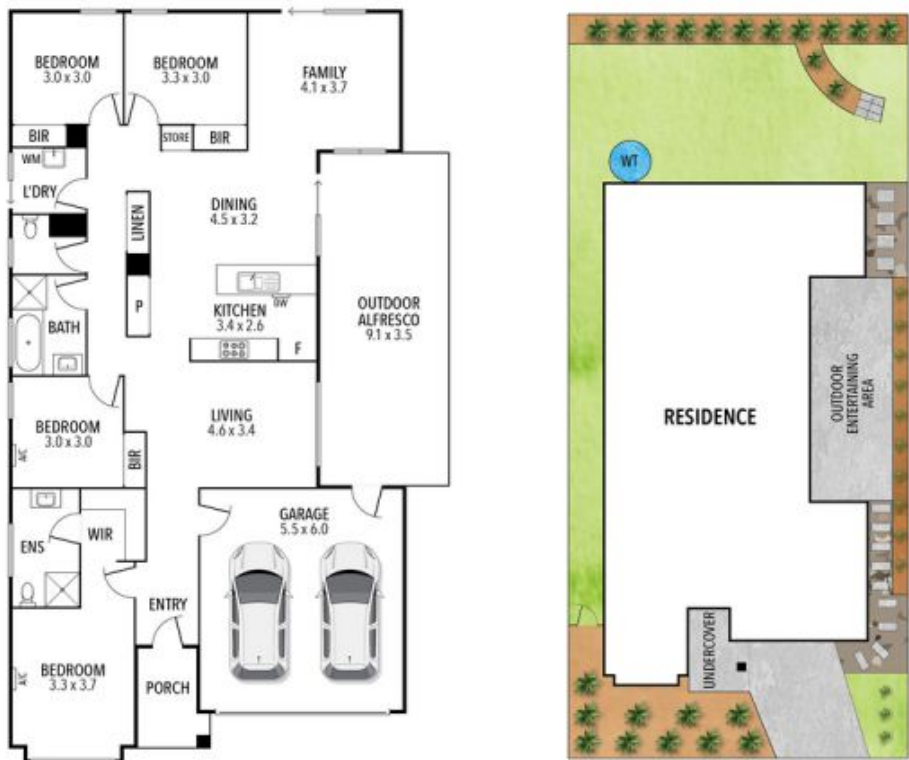

THE ABOVE PLAN IS AN ARTIST'S IMPRESSION ONLY, IT INCLUDES ELEMENTS THAT ARE FOR DISPLAY PURPOSES ONLY AND MAY NOT BE TO SCALE.  
LANDSCAPING SHOWN IS INDICATIVE ONLY. DIMENSIONS ARE APPROXIMATE.

